

FUTEK MODEL QLA183 Idler Sheave Pin Load Cell

STOCK NUMBER: QSH00320

INCH [mm] | R.O. = Rated Output

WIRING CODE			
+Excitation	-Excitation	+Signal	-Signal
RED	BLACK	GREEN	WHITE
+Sense	-Sense	Shield	
ORANGE	BLUE	FLOATING	

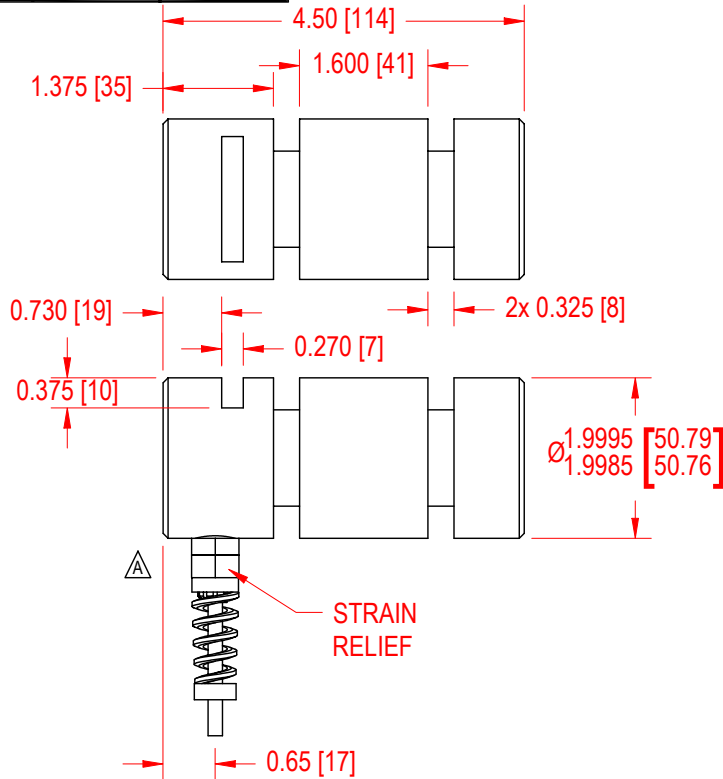
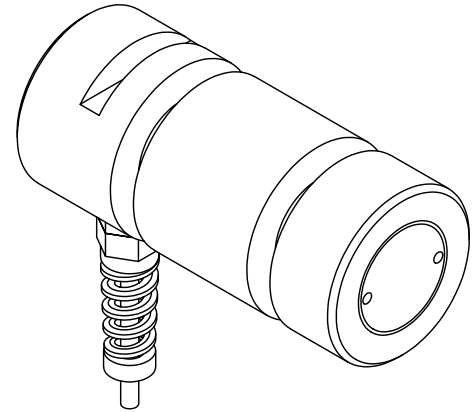

SPECIFICATIONS:

RATED OUTPUT	1.5 mV/V nom.
CAPACITY	7500 lb (33360 N)
SAFE OVERLOAD	150% of R.O.
ZERO BALANCE	±3% of R.O.
EXCITATION (VDC OR VAC)	18 MAX
BRIDGE RESISTANCE	350 Ω nom
NONLINEARITY	±3% of R.O.
HYSTERESIS	±3% of R.O.
NONREPEATABILITY	±0.25% of R.O.
TEMP. SHIFT ZERO	±0.02% of R.O./°F (0.036% of R.O./°C)
TEMP. SHIFT SPAN	±0.02% of LOAD/°F (0.036% of LOAD/°C)
COMPENSATED TEMP.	60 to 160°F (16 to 71°C)
OPERATING TEMP.	0 to 200°F (-18 to 93°C)
WEIGHT	3 lb (1.36 Kg)
MATERIAL	17-4BH S.S.
CABLE: 28 AWG, 6 Conductor Braided Shielded Poly Cable, 5 ft [1.5 m] Long	

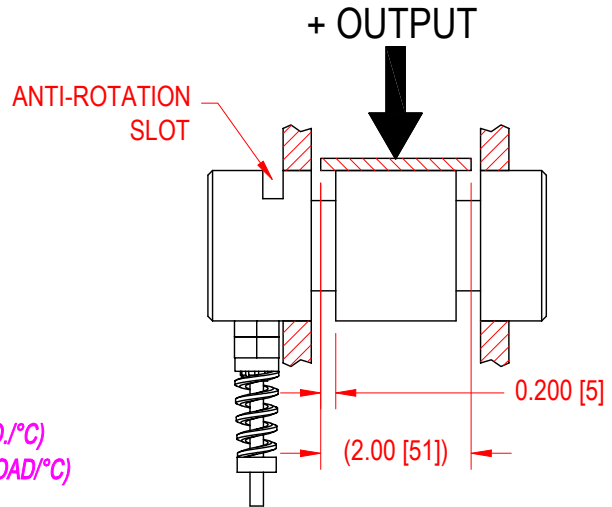

Tel +39

DSPM Industria
sensori & trasduttori

02 48 009 757 Fax +39 02 48 002 070

Via Paolo Uccello 4 - 20148 Milano
info@dspmindustria.it www.dspmindustria.it

MATERIAL:

—

HEAT TREATMENT - FINISH:

—

REVISIONS: (Refer to dwg # revision sheet)

△ 4-5-04

△ 6-4-08

OUTLINE DRAWING

STANDARD NOTES: (Unless Otherwise Specified)

- ALL DIMENSIONS ARE IN INCHES
- DRAWING INTERPRETATION DIMS. PER ASME-Y14.5M
- REMOVE BURRS AND BREAK SHARP EDGES .005 - .015
- THREADS PER HANDBOOK H-28
- DIMENSIONS ARE SHOWN AFTER PLATING

3rd ANGLE PROJ.

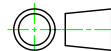

ANGLE:
±1/2°

CHAMFER:
±5°

TOLERANCE:
.XX ±.01
.XXX ±.005

This drawing is submitted solely for the information and exclusive use of the original addressee. It is not to be divulged in whole or in part, by any firm or individual without written permission from:

FUTEK
ADVANCED SENSOR TECHNOLOGY, INC.
10 THOMAS

CAGE: 1X8M6

MODEL: **QLA183**

DWG No.: **FO1039-B**

DRAWN BY: R. WALKER

CHECKED BY: J. VARGAS

APPROVED BY: J. MOKHBERY

DATE: **Apr. 1, 2004**