

FUTEK MODEL QLA167

COMPRESSION GRAM LOAD CELL

ITEM NUMBER: QSH01936



INCH [mm]		R.O.= Rated Output	
WIRING CODE			
+ Excitation	- Excitation	+ Signal	- Signal
RED	BLACK	GREEN	WHITE

COMPRESSION
(+ OUTPUT)

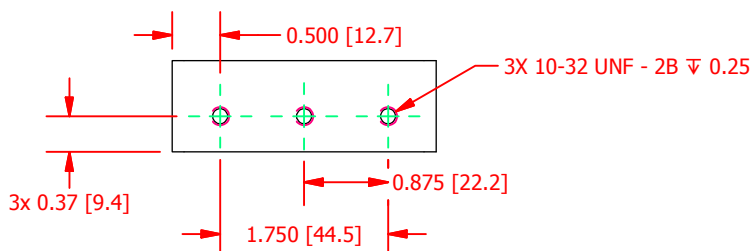
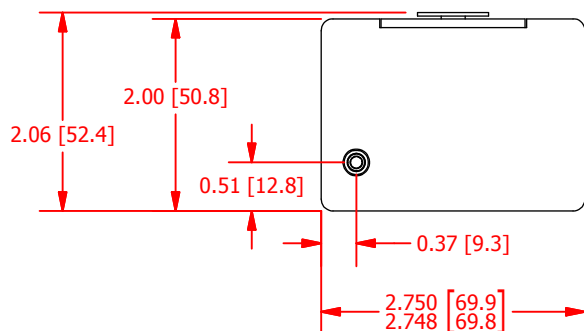
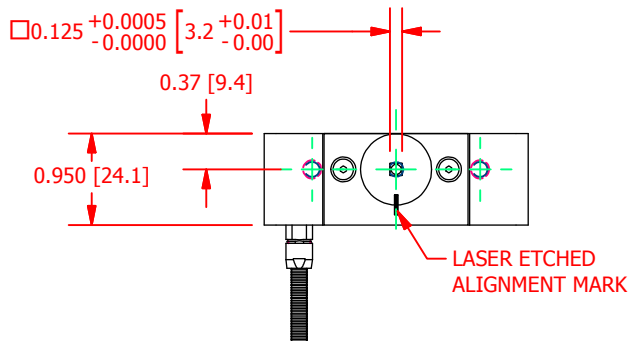
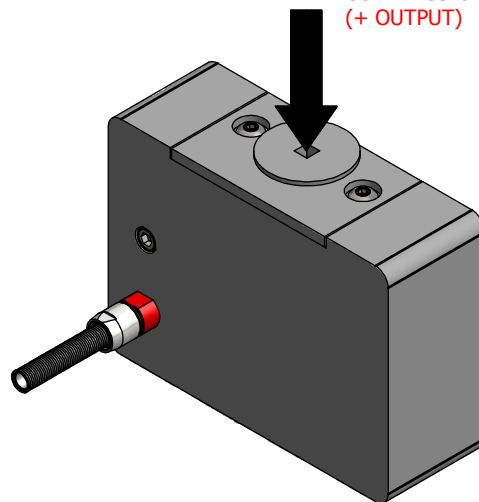

SPECIFICATIONS:

RATED OUTPUT	0.6 mV/V nom.
CAPACITY	10 g
SAFE OVERLOAD	150 % of R.O.
ZERO BALANCE	±3% of R.O.
EXCITATION (VDC OR VAC)	10 MAX
BRIDGE RESISTANCE	1000 Ω nom.
COMPENSATED TEMP.	60 to 120 °F (16 to 49 °C)
OPERATING TEMP	40 to 160 °F (4 to 71 °C)
MATERIAL	ANODIZED ALUMINUM HOUSING
CABLE: #28 Awg 4 Conductor Braided Shielded PVC Cable, 10 ft [3 m] Long	

CUSTOMER APPROVAL- COMPANY:

CUSTOMER APPROVAL- NAME / DATE:

REVISIONS: (Refer to dwg # revision sheet)

OUTLINE DRAWING

STANDARD NOTES: (Unless Otherwise Specified)

ALL DIMENSIONS ARE IN INCHES

DRAWING INTERPRETATION DIMS. PER ASME-Y14.5M

REMOVE BURRS AND BREAK SHARP EDGES .005 - .015

THREADS PER HANDBOOK H-28

DIMENSIONS ARE SHOWN AFTER PLATING

ANGLE:
± 1/2°

CHAMFER:
± 5°

TOLERANCE:
.X ± 0.1"
.XX ± 0.01"
.XXX ± 0.005"

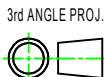

This drawing is submitted solely for the information and exclusive use of the original addressee. It is not to be divulged in whole or in part, by any firm or individual without written permission from:

FUTEK
ADVANCED SENSOR TECHNOLOGY, INC.

MODEL: QLA167	DWG No.: FO1446
DRAWN BY: R. Walker	CREATED DATE: 8/23/2017
APPROVED BY: M. Lisiak	APPROVED DATE: 8/29/2017
CHECKED BY:	CAGE: 1X8M6 SHEET: 1 OF 1